



Kynance Mews London

This is a bright and spacious two bedroom mews house. Comprising a master bedroom with built in wardrobes and en suite bathroom, further double bedroom with en suite shower room, bright and spacious open-plan kitchen and reception room, ceiling window lights and a roof-top terrace. Situated in a very quiet street within sought-after cobbled mews. Kynance Mews is ideally located for the diverse amenities of Gloucester Road and South Kensington with excellent transport links to central London and beyond.

2  2 

Building Size : 943 Sqft
View : <https://www.rickmanproperties.com/7127872>



Viraj Patel MARLA
+44 7947 514483

Kynance Mews, SW7

Approximate Gross Internal Area
Ground Floor = 44.0 sq m / 474 sq ft
First Floor = 43.6 sq m / 469 sq ft
Total = 87.6 sq m / 943 sq ft

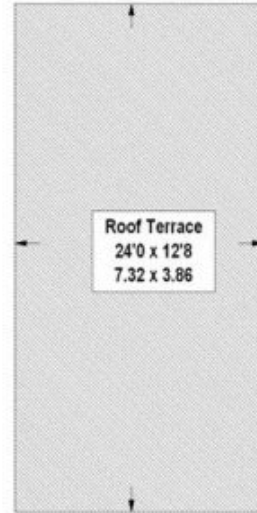

Second Floor



Ground Floor



First Floor

This plan is for layout guidance only. Not drawn to scale unless stated. Windows and door openings are approximate. Whilst every care is taken in the preparation of this plan, please check all dimensions, shapes and compass bearings before making any decisions reliant upon them. (ID 162403)